

Play Area 1

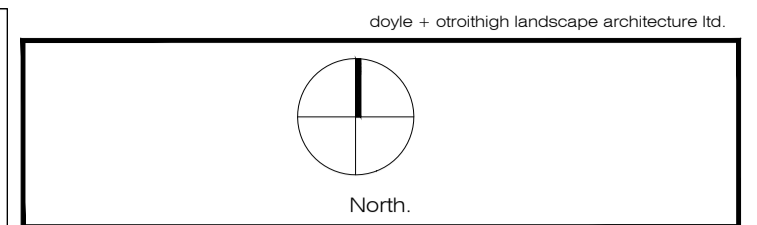
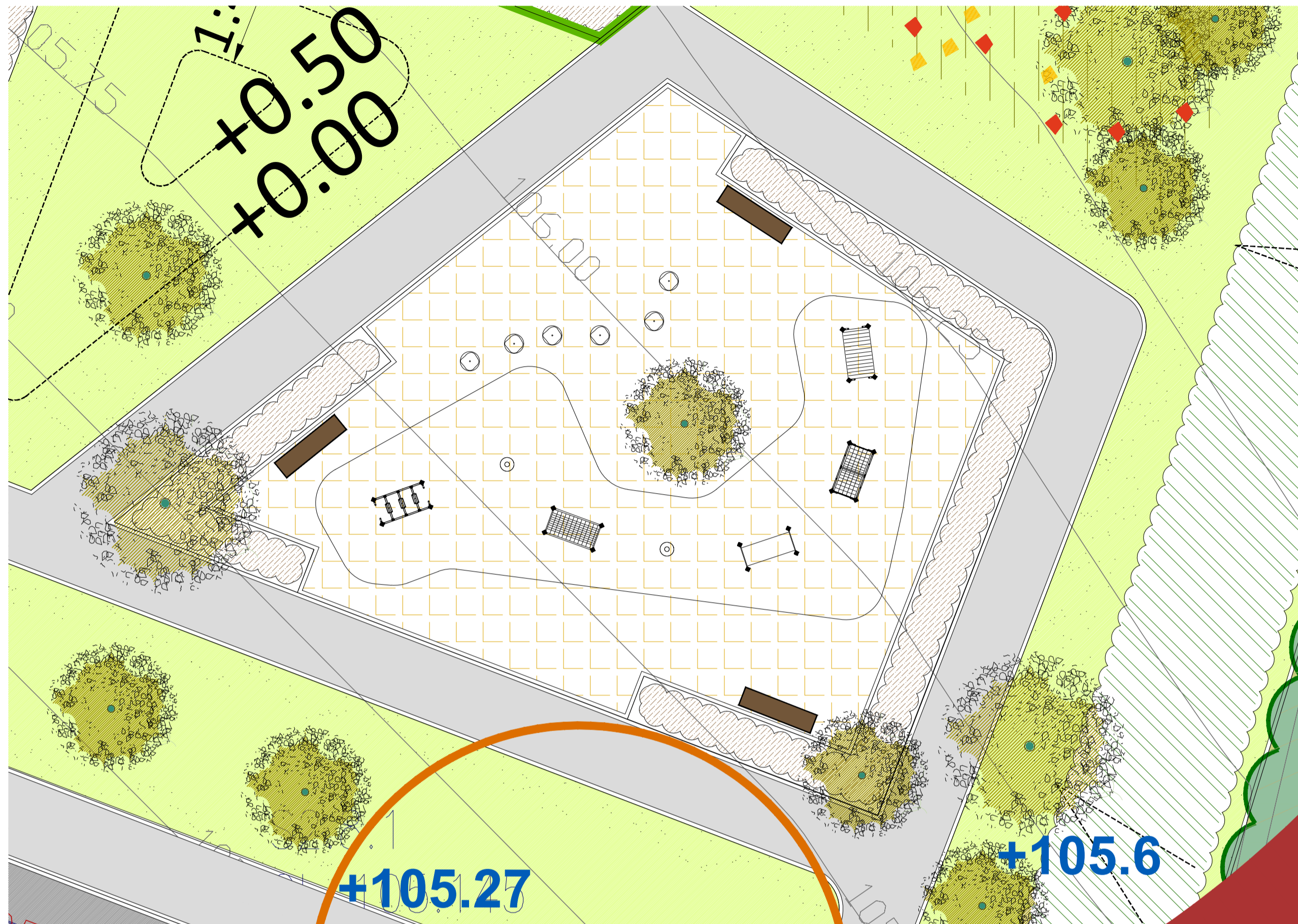

- Legend**
- Proposed Amenity grass areas with public ownership and to public open space: grass seed sown on 150mm clean topsoil (imported if necessary), over 250mm subsoil, all subsoil to be punctured and consolidated to aid natural drainage.
 - Proposed shrub planting areas within public open space, positioned within 450mm clean topsoil (imported if necessary) to areas shown.
 - Proposed beech hedgerow planting: allow for double staggered row with timber post and wire support fence.
 - Proposed open space tree planting - specimen species.
 - Proposed Play area - grass rubberised matting
 - Proposed brushed concrete surface surrounding dwellings and on footpaths through open space.
 - Proposed 1.1M high 1.1M high flat bar topped railing.
 - Proposed feature paving in Open Space: Pre-cast concrete block paving arrangement (silver and charcoal contrasting finish)
 - Proposed seating
- Appropriate root barriers to be installed as necessary where services run close to existing/proposed trees.

Refer to Tree Survey, Tree Constraints drawing, Tree Protection Plan and supporting Arboricultural Impact Assessment as prepared by 'The Tree File' for all detailed information which has been fully co-ordinated with the Landscape Plans.

9142018 Unimini Adventure Trail

HAGS

Unimini Adventure Trail

Product Number: 8055439

Colour: Grey
Material: Steel Post
Anchoring: Cast In Place
Options: Steel Posts

Product Specifications

- Product #: 8055439
- Age Range: 5-12, 3-5
- Product Types: Modular Multi Function Play Equipment
- Brand: Unimini
- Model: Adventure Trail
- Colour: Grey

Technical Information

- Assembly Time: 31 hours
- Length (mm): 13300 mm
- Width (mm): 4100 mm
- Height (mm): 1500 mm
- Net Weight: 367.662 kg
- Volume (m³): 2.65 m³
- Fall Height (mm): 800 mm
- Safety Area Width (mm): 16300 mm
- Safety Area Length (mm): 7200 mm
- Anchoring: Cast In Place

Material	kg	%
Pine	41.0555	9.87
Total	416 kg	100%

<http://www.hags.com/en-us/play/functional-play-equipment/modular-multi-function-play-units-1-5-years/unimini-adventure-trail-2>

eibe complete inspiration

5 55 311 5
balance step 60
made in germany

Scope of delivery
1x Step 60: SW
1x post shoe: galvanised steel

Material	SW pi
Foundation level	FL 3
Minimum space	Ø1'4x2'39 cm
Free falling height	59 cm
Impact protection net	-
Foundations	1x CF
Assembly	1 person/0.2 h
Largest section	57xØ16 cm
Heaviest section	10 kg

[eibeplay Ltd, eibe House | Fonyth's Home Farm | A3 Bypass Road, Hurtmore, Surrey | GU8 6 AD | UK | Fon +44 \(0\)14 83/813 834 | Fax +44 \(0\)14 83/813 851 | eibe@eibe.co.uk | www.eibe.co.uk](http://www.eibe.co.uk)

eibe complete inspiration

5 55 310 5
balance step 40
made in germany

Scope of delivery
1x step 40: SW
1x post shoe: galvanised steel

Material	SW pi
Foundation level	FL 3
Minimum space	Ø1'4x2'0 cm
Free falling height	39 cm
Impact protection net	-
Foundations	1x CF
Assembly	1 person/0.2 h
Largest section	37xØ16 cm
Heaviest section	6.5 kg

[eibeplay Ltd, eibe House | Fonyth's Home Farm | A3 Bypass Road, Hurtmore, Surrey | GU8 6 AD | UK | Fon +44 \(0\)14 83/813 834 | Fax +44 \(0\)14 83/813 851 | eibe@eibe.co.uk | www.eibe.co.uk](http://www.eibe.co.uk)

eibe complete inspiration

5 55 309 5
balance jump-over mushroom Square Dance
made in germany

Scope of delivery
1x standing posts: SW
1x mushroom head: GHP
1x post shoe: galvanised steel

Material	SW pi
Foundation level	FL 1
Minimum space	Ø 3'0x2'39 cm
Free falling height	59 cm
Impact protection net	-
Foundations	1x CF
Assembly	1 person/0.2 h
Largest section	56xØ 30 cm
Heaviest section	6 kg

[eibeplay Ltd, eibe House | Fonyth's Home Farm | A3 Bypass Road, Hurtmore, Surrey | GU8 6 AD | UK | Fon +44 \(0\)14 83/813 834 | Fax +44 \(0\)14 83/813 851 | eibe@eibe.co.uk | www.eibe.co.uk](http://www.eibe.co.uk)

Date	Note

Project name: Proposed Strategic Housing Development at Dunshaughlin East - Phase 2	Project number: 19-048
Drawing name: Play Ground Design Play Area 1 (1of 3)	Drawing number: PG-01-PP

Drawing scale @ A1: 1:100	Drawn by: ad	Checked by: ld
Status: Planning	date: 30.09.2020	

Contact details: Linda Doyle (Director) mobile: 087 267 4196 e-mail: linda@doyle-otroithigh.com Dainh O'Troithigh (Director) mobile: 086 300 3499 e-mail: dainh@doyle-otroithigh.com	Office address: Pembroke House, 28-32 Upper Pembroke St, Dublin 2.
--	---

doyle + otroithigh
landscape - architecture

www.doyle-otroithigh.com